



28 East Hill, Luton, LU3 2EX  
£1,500 Per month



- PR Property Lettings
- Spacious lounge
- Gas central heating
- Available from May

- Three generously sized double bedrooms
- Large kitchen
- Family-friendly location

- Newly decorated throughout
- Great-sized rear garden
- Well-regarded schools nearby

Exclusive to PR Property -Newly decorated throughout and available from May, this well-presented three double bedroom home on East Hill is a fantastic opportunity for families and professionals alike. The property offers a generous lounge, a large kitchen, and a great-sized rear garden — perfect for those who love outdoor space. Gas central heating throughout ensures comfort year-round. Situated in a popular residential area of Luton with well-regarded schools close by, this really is a home worth seeing. Early viewing is highly recommended.

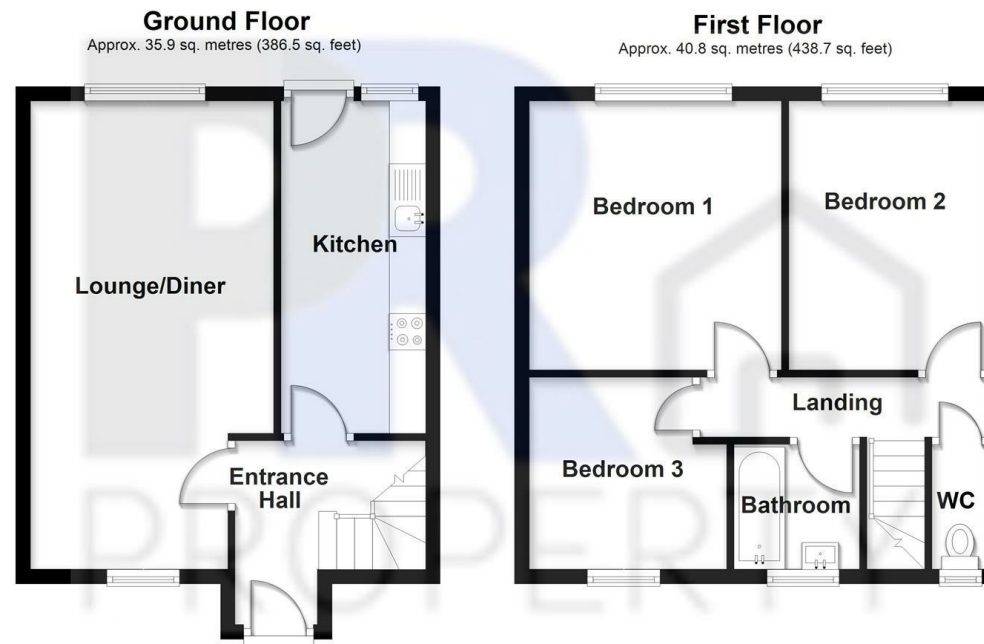

Total area: approx. 76.7 sq. metres (825.2 sq. feet)  
**28 East Hill**

Energy Efficiency Rating		Current	Potential
Very energy efficient - lower running costs			
(92 plus)	A		87
(81-91)	B		
(69-80)	C	70	
(55-68)	D		
(39-54)	E		
(21-38)	F		
(1-20)	G		
Not energy efficient - higher running costs			
England & Wales		EU Directive 2002/91/EC	